



## SBS10165 SERIES ~ Shielded SMD Power Inductors



### PART NUMBERING SYSTEM

<b>SBS</b>	<b>10165</b>	—	<b>220M</b>	—	<b>LF</b>
TYPE	DIMENSIONS		INDUCTANCE		LEAD FREE

### SHAPES AND DIMENSIONS

UNIT : mm

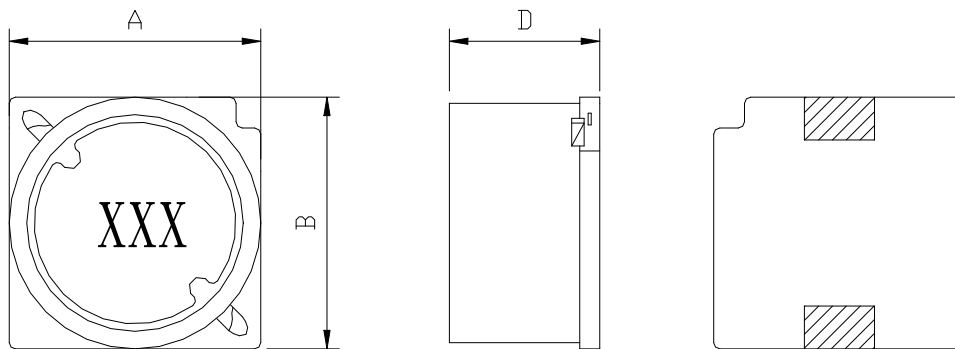

A=10.4 Max. B=10.4 Max. D=7.0 Max.

### RECOMMENDED PATTERNS

UNIT : mm

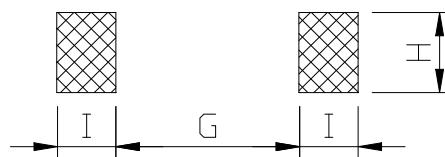

G=5.6 H=3.2 I=2.5

### FEATURES

- Magnetically shielded construction
- Suitable for large current
- Ideal for a variety of DC-DC converter inductor applications .
- RoHS compliant .

## SBS10165 SERIES ~ Shielded SMD Power Inductors



### SPECIFICATION TABLE

PART NUMBER	INDUCTANCE ( $\mu$ H)	DCR (m $\Omega$ ) (Max.)	Isat (A) ( Max. )	Irms (A) ( Max. )	TEST FREQ. ( f )
SBS10165-1R5N-LF	1.5 $\pm$ 30%	8.71	10.7	6.80	100KHz
SBS10165-2R2N-LF	2.2 $\pm$ 30%	10.92	8.90	6.30	100KHz
SBS10165-3R3N-LF	3.3 $\pm$ 30%	12.48	7.80	5.80	100KHz
SBS10165-4R7N-LF	4.7 $\pm$ 30%	15.21	6.10	4.70	100KHz
SBS10165-6R8N-LF	6.8 $\pm$ 30%	18.20	4.60	4.30	100KHz
SBS10165-100M-LF	10 $\pm$ 20%	24.05	4.10	3.80	100KHz
SBS10165-150M-LF	15 $\pm$ 20%	35.10	3.10	3.10	100KHz
SBS10165-220M-LF	22 $\pm$ 20%	58.24	2.70	2.40	100KHz

- Isat : DC current at which the inductance drops 10% (typ) from its value without current.
- Irms: The actual current when temperature of coil becomes  $\Delta 40^{\circ}\text{C}$ . (  $T_a = +25^{\circ}\text{C}$  )
- Operating temperature range  $-40^{\circ}\text{C}$  to  $+125^{\circ}\text{C}$  ,
- Electrical specifications at  $25^{\circ}\text{C}$ .

### PACKAGING SPECIFICATION

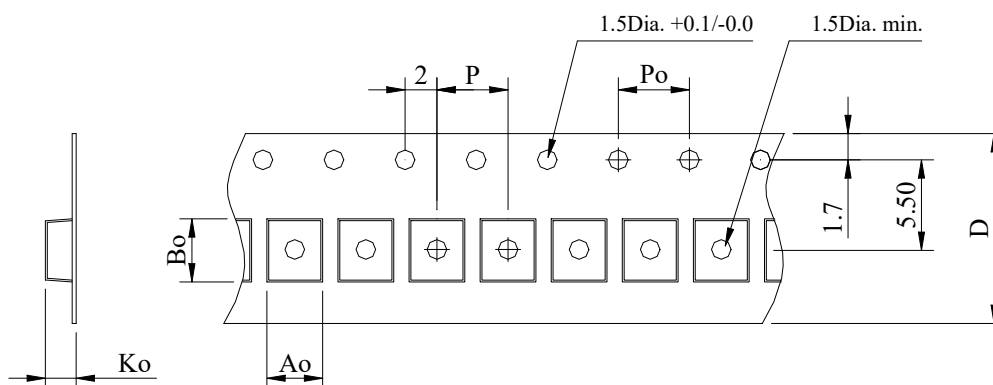

STAYLE	Q'TY (PCS)	DIMENSIONS (m/m)					
		Ao	Bo	Ko	P	Po	D $\pm 0.3$
13"	500	10.70	10.70	5.30	8.00	4.00	12.0